

LIVE ON

2010

2011

UNIVERSITY OF SOUTHERN INDIANA

HOUSING/FOOD SERVICES BOOKLET

HOUSING
CONTRACT
NOW ONLINE
WWW.USI.EDU/RES



Congratulations on your admission to the University of Southern Indiana.

You've chosen USI as your university. Now discover where you will live during your college experience. Many things, like convenience, safety, and cost, will impact your decision.

This booklet will help you plan how you will connect with fellow students, University services, library facilities, and computer resources. Also think about how you will navigate this dynamic, innovative, and challenging university. We think you will see that campus housing is the right place for you.

Inside, you will find information about campus housing and directions to the online contract. The priority deadline for housing is April 1, 2010, so don't delay, apply today!

With Screaming Eagle Pride,

The Housing and Residence Life Team

Inside

Campus Living	1
Living Learning Communities	7
Communities and Rooms	11
Food Services	17
How to Apply & Timeline	21
Break/Holiday Housing	25
Disability Accommodations	25
Housing Placement	27
Payments and Contracts	29
Rates	29
Completing Your Contract	31

CAMPUS LIVING: ADVANTAGES



Accept the Challenge!

College is a time of transition—and a time of preparation. Living on campus is an outstanding way to prepare for life beyond the college experience. You will learn basic living skills like cooking, laundry, cleaning, and budgeting, and you will be introduced to new viewpoints and cultures. When you become part of our housing community, you take advantage of the rich variety of educational, social, and recreational activities that will help you now and in the future.

Academic Support

Campus housing provides educational programs, living-learning communities, computer labs, study lounges, and quiet hours to maintain an environment supportive of academic success.

Choice

First-year students may choose to live in campus apartments or in the residence halls. Students who choose residence hall living may decide to live in one of 10 different first-year living-learning communities. Students in their second, third, and fourth years may choose to live in one of four different apartment areas.

Technology Services

All campus housing facilities have direct Ethernet connections and wireless Internet access to serve your academic needs. Computer labs are located in the residence halls and in the Housing and Residence Life Center. Students are close to University computer labs and can get technical support from the USI Computer Center.

Convenience

By living on campus, you are always close to academic buildings, Rice Library, the Recreation and Fitness Center (RFC), campus activities, athletic events, campus dining options, and the campus shuttle bus. Because things are convenient, you seldom have to search for a parking space, something to do, or help when you need it.

Friendship

From the day you move in, you'll find a variety of orientation, educational, and social programs that help ease your transition to USI. Living on campus provides the best environment for expanding your understanding of people and for making new friends.

Involvement

Campus living also provides great ways to easily get involved in USI campus life by joining clubs and organizations, participating in intramurals, attending athletic events, taking on leadership roles, exploring academic programs, and simply kicking back and hanging out with friends.

Safety and Security

Campus housing is staffed with full-time professional and student staff who are dedicated to supporting your success at USI. Housing staff members are available and on call. USI Security always is available to assist you.

Save Money

Campus living is affordable, maintenance free, and your bills are predictable. Cable television, Internet service, utilities (electric, water, sewage, local phone), and shuttle bus service are provided at no additional cost. This leaves you free to focus on the most important things—your academic and personal success!

CAMPUS LIVING: ADVANTAGES



We have what you need to succeed!

Whether you are in a campus apartment or one of the residence hall suites, you will have all you need to succeed. All rooms are furnished, and are equipped with a telephone, phone services, and wired and wireless Internet access. Utilities are included in your housing rate. Even basic expanded cable service is available—you simply provide the television. All campus communities have laundry facilities for student use and parking near where you live.

Campus Housing is divided into five communities:

1. Residence Halls

Newman, Governors, O'Bannon, and Ruston halls are located to the east of University Boulevard, across from the academic buildings and adjacent to the Recreation and Fitness Center and Rice Library.

2. O'Daniel South

This group of 10 apartment buildings is on the northeast side of campus, near the Office of Religious Life and OSCARS (Office of Student Conduct and Resolution Services).

3. O'Daniel North

Within this area of 11 apartment buildings is the Housing and Residence Life central office, mail center, and computer lab.

4. McDonald East

These apartments offer easy access to Schutte Road or the main campus. Fraternity and sorority housing is located in McDonald East.

5. McDonald West

This community has nine apartment buildings and the newly renovated Residence Life Community Center, which includes a large laundry facility, open community space, fireplace, and convenience store.

Housing and Residence Life Staff

Each community has a full-time, live-in professional area coordinator (AC), experienced in working with students, and with an educational background that includes higher education, counseling, or human services. Area coordinators select and train the student staff, provide on-site facilities management, and ensure that programs and activities in your community support your involvement and connection to USI.

Your primary connection is your resident assistant (RA). An RA is a student-staff member selected for leadership skills, an ability to reach out to peers, and a capacity to connect students to the resources they need to be successful.

Resources

Living on campus puts you close to USI resources including Rice Library, Recreation, Fitness, and Wellness Center, athletic events, activities, professors, support services, and food service options, which are within walking distance for students. Shuttle busses serve all areas of campus housing. By living on campus, you will benefit from being "in the know" about everything USI.

Involvement

As you interact with others to form friendships, develop community, and schedule activities that you and your friends enjoy, you will be energized by the diversity of fellow students represented in the communities. You won't be disappointed when you look for ways to get involved.

Technology

USI Residence Life offers you two ways to get the Internet connection you need. Direct Ethernet connections and wireless access allow you to stay in touch with family, friends, and new neighbors. This access also connects you to USI's powerful web site (www.usi.edu) and to the myUSI information portal.

Healthy Atmosphere

Students living in housing are required to have all immunizations up to date prior to moving into University housing. The immunization form is included in the Admitted Student Packet sent by the Office of Admission and must be completed and submitted to the Student Health Center, 812/465-1250. Resident assistants and various departments offer programs on health, nutrition, and fitness throughout the academic year.

CAMPUS LIVING: OPTIONS



How do I choose where to live?

- Visit the USI campus. Contact the USI Office of Admission at 812/464-1765 or toll-free at 800/467-1965 to arrange a campus visit or to register for a Southern Hospitality Day (campus visit days). Or, visit us on the web—www.usi.edu/admissn/visit.asp.
- Take a USI Virtual Tour—www.usi.edu/virtualtour/index.asp
- Carefully read the room descriptions in this brochure.
- Remember, residence halls are for first-year students only.

If you have questions, contact us at living@usi.edu or by telephone at 812/468-2000.

Smoke-free

All University of Southern Indiana buildings and rooms are smoke-free, including campus housing.

Substance-free

USI is committed to keeping all campus areas substance free, which means that alcohol and drugs are not allowed in campus housing. A substance-free environment helps support academic success for USI students.

Single Rooms

A limited number of single rooms are available in the residence halls. These studios combine bedroom and living space and have a private bathroom.

Private Bedrooms

Private bedrooms are available to students at a higher cost. These rooms are for one person and include a double bed, a private bathroom, and additional amenities. These rooms are available on a first-come, first-served basis.

Quad Rooms

USI apartments and residence hall suites are designed for four people. Each has two bedrooms, two people to a bedroom. This is the most typical room configuration and the one selected by most of our students.

Living Learning Communities

First-year students may apply to be a part of our dynamic and interactive Living Learning Communities (LLCs), located in Ruston and O'Bannon halls. LLCs are programs designed to link the in-class and out-of-classroom experiences and help students make a smooth and successful transition to college life. A separate application is required. Details about the LLC program can be found on pages 7-10.

LIVING LEARNING COMMUNITIES



Living Learning Community (LLC) students are immersed in a true living and learning environment. Residents live in close proximity to other students who share the same major or interest and attend classes together. Students select from 11 LLC options: Business; Elementary Education, Early Childhood, and Special Education; Emerging Leaders; Exploring Majors; Global Community, Honors; Liberal Arts; Nursing and Health Professions; Social Work; STEM (science, technology, engineering, and mathematics); and Sophomore Year. Different University departments sponsor each floor or apartment community and assist in organizing programs, activities, and events highlighting various themes. Student staff members, Resident Assistants (RAs), are tied to an academic major or theme and many have been a part of the LLC. Each LLC has a distinct culture and personality. All but the Sophomore Year have common courses. A one-hour pro seminar taught by sponsoring faculty creates a shared experience for students, enhancing positive bonds both in and out of the classroom. Students participating in LLCs have a higher GPA than those who do not participate in the program.

LLCs provide many advantages:

- Living with students of the same major or interest
- Common courses through seminar or block scheduling
- Built-in academic support through formal or informal study groups
- Programming around a central theme
- Link to sponsoring faculty and staff

For more information on any of the LLCs, contact Amy Price, Associate Director of Housing and Residence Life, asprice@usi.edu, or call 812/468-2000.

Business Living Learning Community introduces freshman business students to university life and USI's College of Business majors. These students share a common interest in business, live on the same wing in the residence hall, and take two core curriculum classes together each semester along with a University 101 course. The business major RA helps guide, support, and mentor new students. Faculty sponsor: Tim Mahoney (TMahoney@usi.edu)

Education Living Learning Community was created to provide freshmen, interested in teaching, the opportunity to learn early in their program what is involved in becoming a teacher. The fall term offers a one-hour class which provides information about success strategies for college, the USI Teacher Education program, and features guest speakers. Your schedule in both the fall and spring includes classes that all members of the education

community take at the same time. Being involved with this community provides the opportunity to build lasting friendships that will support you throughout your program here at USI. Faculty sponsor: Joyce Gulley (jagulley@usi.edu)

Emerging Leaders Community helps freshmen get involved in USI's student organizations, campus entertainment, intramural sports, and other programs that provide the fun and fulfillment of the full college experience. Students in this community also explore leadership topics such as teamwork, communication, time-management, and service that will help them become the future leaders on USI's campus. The Emerging Leaders LLC provides its students with the chance to make important friendships and connections with other student leaders, faculty, and staff on campus. Staff sponsor: David Duvall (dpduvall@usi.edu)

Exploring Majors Living Learning Community provides a supportive and challenging learning community for students without a chosen major or career direction in mind. This LLC provides students intentional opportunities to engage in the major/career exploration process and better understand their own strengths, interests, and abilities. Residents have access to programming, including workshops, special events with faculty in a variety of academic disciplines, and Internet-guided major and career exploration. One of the most popular features of the program involves field experiences that provide students with a behind-the-scenes look at various careers in the Evansville community. Staff sponsor: Michael "Brody" Broshears (mbsroshears@usi.edu)

LIVING LEARNING COMMUNITIES



Global Community is a multicultural LLC with American and international students who love to share their cultures. Students learn about the world and themselves through the exploration of cultures and global issues by interacting with one another on a daily basis. Weekly programs are offered that provide residents with a diverse view of different countries, cultures, and customs. Staff sponsor: Andrea Barnard (arbarnard@usi.edu)

Honors Community provides students with opportunities to take trips, work directly with faculty on academic projects, gain volunteer experience, and take classes with other Honors students. It rewards students for academic performance and assists them in making the most of their college experience. Students become better acquainted with the Evansville community, with USI, and with the Honors Program. Honors and community events are fun and educational. Faculty sponsor: Antonina Bambina (adbambina@usi.edu)

Liberal Arts Learning Community has been created for freshmen interested in discovering the interdisciplinary nature of knowledge, developing values and skills for civic engagement and responsible global citizenship, and connecting learning to the world beyond the classroom. The USI College of Liberal Arts prepares students for future careers, graduate programs, and good citizenship through its 30 majors within 10 academic departments: Art; Communications; English; History; Modern & Classical Languages; Performing Arts; Philosophy, Political Science & Public Administration; Psychology; Sociology, Anthropology, & Criminal Justice Studies. Faculty sponsor: Maggie Felton (MFelton@usi.edu)

Nursing and Health Professions allows first-year students interested in this field to make an easier transition into college. Because residents take block courses together, study partners or groups naturally develop. The LLC also provides a great support system for students as they can discuss concerns about courses, grades, and instructors with students having similar experiences. Faculty sponsor: Beth Thompson (BThomps@usi.edu)

Social Work Community hopes to make your transition to college easier. The benefits of living in an LLC include more faculty contact, becoming a leader on campus, exploring your major sooner, and creating meaningful experiences with a group of people that have the same interests as you. You will take courses with those you live with and participate in residence hall activities together. Faculty sponsor: Kathy Elpers (kelpers@usi.edu)

STEM (science, technology, engineering, mathematics) is a community where students with an interest in biology, chemistry, engineering, geology, or math really want to live. Residents get the opportunity to meet students who are fascinated by similar things, to make new friends, or to participate in activities that intrigue them, such as a chemistry experiment or bridge-building competition. Faculty sponsor: Edmir Wade (eowade@usi.edu)

Sophomore Year If you enjoyed the first-year LLCs, then this is the place for you. This community builds on the experiences developed in the previous LLCs. If you were unable to take advantage of the LLC experience last year, you can still apply to participate this year. The LLC is located in the apartment area and works with your RA and staff to create bonds of common interests, and participation within the University and local communities. Staff sponsor: Amy Price (asprice@usi.edu)



COMMUNITIES AND ROOMS



Newman Hall, Governors Hall, O'Bannon Hall, and Ruston Hall

Newman and Governors halls accommodate over 340 residents; O'Bannon and Ruston halls over 400. Men and women reside in separate suites. All four halls are freshman only. Newman and Governors halls are in close proximity to the Recreation, Fitness, and Wellness Center and directly across the boulevard from the new Rice Library. O'Bannon and Ruston halls are near the Screaming Eagles Valley Complex and the Art Studio. Ruston and O'Bannon halls house first-year Living Learning Communities.

- freshman-only buildings
- interior hallways
- suite-style layout
- two bathrooms in each two-bedroom suite
- limited number of studio rooms with one room and adjoining bath
- large first-floor lounge in each hall
- additional lounge space on second and third floors (O'Bannon and Ruston halls)
- vending machines in each building
- laundry room
- computer labs on each wing
- living area includes couch, chair, and mini-kitchen area with sink, under-the-counter refrigerator (provided), and storage cabinets
- bedrooms have desks, chairs, and bunk/loft beds
- carpeting
- 695 square feet in two bedroom suites
- overhead lighting
- ample outlets for individual lamps (not halogen)
- individual temperature controls by suite
- four people per suite, two per bedroom, except in the one-bedroom studios
- all halls have six computer labs; rooms are equipped with ethernet connections and wireless Internet access



COMMUNITIES AND ROOMS



O'Daniel South and O'Daniel North Communities

Located on the east side of campus, the O'Daniel South Apartment Community is home to over 650 residents and is the largest housing community. North of Clarke Lane in the heart of the apartment area, the O'Daniel North Apartment Community is home to over 600 residents. Both communities house first-year to fourth-year students and are home to many campus activities. Men and women are housed in separate apartment units. O'Daniel South also is home to USI's Office of Religious Life, the O'Daniel South volleyball court, Student Housing Association office, Office of Student Conduct and Resolution Services (OSCARS), and Meditation Trail. O'Daniel North is home to the USI Residence Life Office, the mailroom for O'Daniel South and O'Daniel North residents, and the Residence Life apartment area computer lab.

- O'Daniel South consists of 10 apartment buildings; O'Daniel North consists of 11
- limited number of single apartments (one bedroom, once person), private bedroom in a two bedroom unit, and shared one bedroom apartments (one bedroom, two person)
- all floors have exterior door entrances and a split bedroom layout
- each bedroom has accompanying private bathroom
- each apartment equipped with full kitchen, including range and oven, full-sized refrigerator/freezer, sink, garbage disposal, and cabinets
- vending machines available throughout the buildings
- large laundry room in O'Daniel South
- O'Daniel North offers access to lounge areas in Residence Life center, with computer lab access
- living areas include couch, chair, end table, and coffee table
- dining areas equipped with dining table and four chairs
- bedrooms include two desks, two chairs, nightstand, two beds with mattresses, and two dressers
- carpet
- 700 square feet
- overhead lighting
- ample outlets for individual lamps (not halogen)
- two air conditioning units—individually controlled
- four people per apartment, two per bedroom
- bedrooms equipped with ethernet connections and wireless Internet access

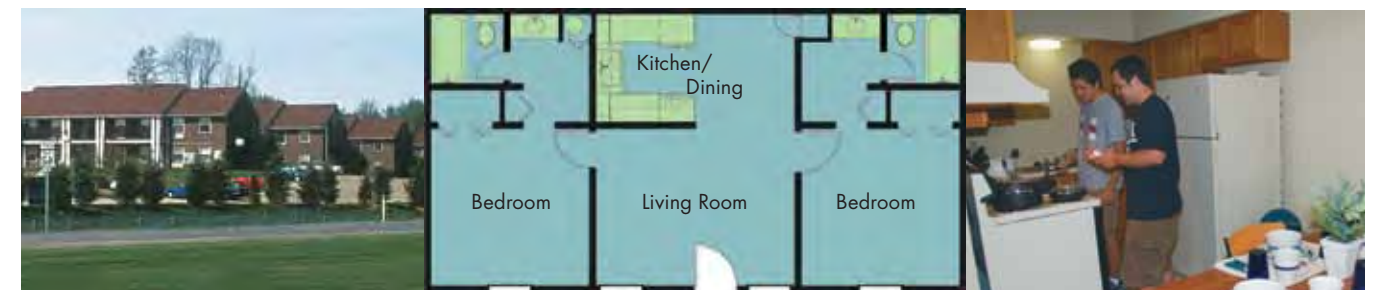

COMMUNITIES AND ROOMS



McDonald West and McDonald East Communities

McDonald West Apartment Community, housing over 550 first-year to senior-level residents, is home to the Residence Life Community Center, which includes a large meeting space, laundry room, a basketball court, and sand volleyball courts. The McDonald East Apartment Community, where mostly junior, senior, and graduate students reside, is home to 360 residents, and includes four buildings for Greek organizations. Both communities house men and women in separate apartment units.

- McDonald West consists of nine apartment buildings
- McDonald East includes 13 apartment buildings
- limited number of private bedroom in a two bedroom unit, and shared one bedroom apartment (one bedroom, two person)
- McDonald West apartment buildings offer exterior door entrances and a split bedroom layout
- McDonald East apartment buildings have interior door entrances
- each bedroom has accompanying private bathroom
- apartments equipped with full kitchen, including range and oven, full-sized refrigerator/freezer, sink, garbage disposal, and cabinets
- some McDonald East apartments are equipped with dishwasher
- vending machines available throughout both complexes
- laundry facilities available in each apartment building in McDonald East community; a large laundry room is located in Residence Life Community Center
- living areas include couch, chair, end table, and coffee table
- dining areas equipped with a dining table and four chairs
- bedrooms have two desks, two chairs, nightstand, two beds with mattresses, and two dressers
- carpet
- 700 square feet
- overhead lighting
- ample outlets provided for individual lamps (not halogen)
- McDonald West provides two air conditioning units per suite—individually controlled
- McDonald East provides central air conditioning
- four people per apartment, two per bedroom
- each bedroom equipped with ethernet connections and wireless Internet access



McDonald West



McDonald East

FOOD SERVICES



USI Food Services provides a wide range of dining options, with menus that vary from hometown favorites to international cuisine, high-quality food, and a wide variety of choices, all at an excellent value. USI Food Services offers resident dining, retail markets and cafes, and catering services.

In many of our dining facilities, much of the food is freshly prepared as you watch. The Loft, our primary residential dining facility, is staffed with a professional chef, manager, and a team of experienced food service staff. You'll also find favorite food items are available, such as assorted pizzas, burgers, fresh salad bar, your favorite beverages, and freshly baked desserts.

Burger King, Sub Connection, Pete's Arena, Café a la Cart, Starbucks, and Eagle Express Convenience Store can provide you with additional dining variety. By choosing one of our meal plans, you have the freedom to eat at any food service location, shop for clothing or groceries at Eagle Express, or purchase merchandise at Eagle Express and Starbucks.

Which Meal Plan is Right for Me?

Choosing the meal plan that's best for you depends on many things—including how many meals you generally eat each day, your weekly schedule, and how active you are. There are a variety of plans from which to choose, so take a look at the options below to find one that is right for you. Not interested in a meal plan, but still want to dine on-campus in a convenient way? Try Munch Money, our pre-paid account for food service. Munch Money, when added to the Eagle Access Card, will be granted an additional five to ten percent bonus to be used in food service operations. Contact USI Food Services at 812/464-1859 for more information.

Resident Meal Plans (for students in residence halls and apartments)

Red Eagle Plan (\$1,680/semester)

This plan includes 12 buffet meals (you may choose from five breakfast buffets, two brunches, and seven dinner buffets) each week. Each student also will receive \$480 in dining dollars per semester on his/her Eagle Access Card to be used at any food service location. Evening meals are available in either The Loft for the all-you-can-eat buffet or in the designated retail area for a combo meal. The exchange combo meal is available daily from 3 p.m. to closing. Refer to www.usi.edu/food for hours of operations.

White Eagle Plan (\$1,680/semester)

This plan includes 11 buffet meals (you may choose from five breakfast buffets, two brunches, and seven dinner buffets) each week. Each student also will receive \$525 in dining dollars per semester on his/her Eagle Access Card to be used at any food service location. Evening meals are available in either The Loft for the all-you-can-eat buffet or in the designated retail area for a combo meal. The exchange combo meal is available daily from 3 p.m. to closing. Refer to www.usi.edu/food for hours of operations.

Blue Eagle Plan (\$1,680/semester)

This plan includes nine buffet meals (you may choose from five breakfast buffets, two brunches, and seven dinner buffets) each week. Each student also will receive \$590 in dining dollars per semester on his/her Eagle Access Card to be used at any food service location. Evening meals are available in either The Loft for the all-you-can-eat buffet or in the designated retail area for a combo meal. The exchange combo meal is available daily from 3 p.m. to closing. Refer to www.usi.edu/food for hours of operations.

Apartment/Optional Meal Plans (apartment residents only)

Titanium Card Plan (\$1,099/semester)

A student using this plan may eat up to 70 dinners or brunches at The Loft. Each student also will receive \$610 in munch money on his/her Eagle Access Card that can be used in any food service location. Munch money, when added to the Eagle Access Card, will be enriched an additional five to ten percent, depending on the amount of funds added, to be used in food service operations.

Platinum Card Plan (\$819/semester)

A student on this plan may eat up to 50 dinners or brunches at The Loft. Each student also will receive \$435 of munch money on his/her Eagle Access Card that can be used in any food service location. Munch money, when added to the Eagle Access Card, will be enriched an additional five to ten percent, depending on the amount of funds added, to be used in food service operations.

Gold Card Plan (\$590/semester)

A student on this plan may eat up to 31 dinners or brunches at The Loft. Each student also will receive \$345 of munch money on his/her Eagle Access Card that can be used in any food service location. Munch money, when added to the Eagle Access Card, will be enriched an additional five to ten percent, depending on the amount of funds added, to be used in food service operations.

FOOD SERVICE OPERATIONS



Where can I eat?

USI Food Services is committed to offering you great service, convenience, variety, and quality, all at an affordable price. Many dining and retail food options—ranging from our dining hall, to our café, to our convenience store—are available to provide you with the best dining experience possible!

The Loft

For a relaxing dining experience, visit The Loft, located on the second floor of the University Center. The Loft features a theme bar, fresh salad bar, soups, pizza and pasta station, vegan and vegetarian options, and Charleston Market, offering a selection of hot entrees, rotisserie meats, potatoes, and a variety of vegetables for lunch and dinner. The Loft also offers an all-you-can-eat breakfast buffet each weekday morning and brunch on the weekends.



Pete's Arena

Everybody craves good, old-fashioned pizza pie. At Pete's Arena, located on the first floor of the University Center, the pizza is as traditional as pizza can get. Delicious and hearty—just what you'd expect. Other offerings at Pete's include strombolis, calzones, pasta, chicken strips, and fresh salads.

Burger King

For a quick meal on the go, Burger King has flame-broiled burgers and chicken, along with salad and dessert. There is something for everyone. Whether for breakfast, lunch, or dinner, come to Burger King to eat great "on the go."



Sub Connection



Have you made the connection? The aroma of fresh-baked bread is from The Sub Connection, where we offer made-to-order sub sandwiches with a variety of toppings. Soup and fresh salads also are available at our location on the first floor of the University Center.

Eagle Express Convenience Store

Located in the Residence Life Community Center, the convenience store is packed with many popular household and grocery items to meet your needs. You also can enjoy an old-fashioned pizza pie from the Pete's Arena Eagle Express location.



Café a la Cart

Café a la Cart, with two locations to serve you—in the Link between the Health Professions Center and the Science Center, and in the Liberal Arts Center—is ideal for those with a tight lunch schedule. Café a la Cart features coffee and bottled beverages plus a variety of fresh-baked goods and freshly made salads and sandwiches.

Starbucks Coffee

Share the experience that keeps people coming back and rely on the magical combination of three things: our products, our places, and our guests. You will come for coffee, stay for inviting warmth, and return for the very human connection. You will find us located in Rice Library.



Please Note

- Meal plan participants must present a valid USI Eagle Access Card or pay the posted casual meal rate to be admitted to The Loft.
- Meal plans and Munch Money may not be transferred to another student. If it is discovered that a person is using a "borrowed" Eagle Access Card, Food Services will confiscate the card and the student(s) will be referred to the University for violations of the USI Student Rights and Responsibilities: A Code of Student Behavior.
- Meal plans officially begin on August 28, 2010, and end on May 6, 2011. Meal plans are not in operation during holiday break periods.

HOW TO APPLY AND TIMELINE



Applying for Housing

Two Ways to Apply:

- Visit our web site to apply online at www.usi.edu/res, and pay your \$200 deposit with a credit card.
- Contact our office at 812/468-2000 or email living@usi.edu to request an application (only available for students who have been admitted to USI).

Please note – this contract is an academic year contract and is binding from the receipt of your contract and \$200 deposit through May 8, 2011.

Application and Assignment Timeline

- **March 1, 2010 – deadline to request a specific roommate** – You can select to live with **one** specific roommate of your choice. This roommate choice must be mutual (both students must request it) and must be indicated on both students' contract forms. Every effort will be made to honor this request, but this will only be **guaranteed** if **both** students' contracts and deposits are received by the priority date of March 1, 2010, and the **request is mutual**. Roommate pair must request the same room preference type.
- **March 1, 2010 – deadline for Living Learning Community application** – Living Learning Community applications received after this date will be evaluated, and students accepted after this deadline will be placed on a waiting list.
- **April 1, 2010 – deadline for current students (students currently living on campus) to cancel their 2010-2011 contract with no penalty** – Contracts for current students signed after April 1, 2010, and then cancelled, will result in a loss of the \$200 deposit.
- **April 1, 2010 – PRIORITY DEADLINE FOR CAMPUS HOUSING** – Contracts received after this date will be assigned on a space-available basis.
- **June 1, 2010 – deadline for new students (incoming freshmen or new transfer students for the 2010-2011 academic year) to cancel their 2010-2011 contract with no penalty** – Contracts for new students signed after April 1, 2010, and then cancelled, will result in a loss of the \$200 deposit.
- **July 15, 2010 – Room assignments sent to students with completed housing contracts and paid deposits received by July 1, 2010** – Assignments and roommate information for students whose contracts and deposits were received after July 1, 2010, will be sent each Friday after the July 15, 2010, date. Understand, there is no guarantee that this will be your permanent assignment or roommate(s).
- **August 1, 2010 – Move-in information will be emailed to all assigned students. This mailing includes move-in dates and times, as well as information about important University services.**
- **August 1, 2010 – Last day to apply for early arrival (\$18/night charge applies)** – If you need to arrive earlier than the official opening date, you must request advanced approval in writing from the Housing and Residence Life Center by August 1, 2010. You must fill out the online form at www.usi.edu/res. Students must have a valid University-related reason for early check in. Those without Housing and Residence Life approval will not be allowed to check in early.
- **August 18, 2010 – First day students can move in early** – Services normally offered will not be available prior to the August 26, 2010, move-in date. Students approved to arrive early will be charged \$18/day prior to the official opening date. Students must keep their apartment or residence hall suite clean during this interim period. Rooms that are dirty on the dates of official move-in will be charged a \$150 cleaning fee. Students who refuse to allow someone to move in may face disciplinary action.
- **August 26, 2010 – University housing official check-in for Welcome Week participants**
- **August 27–29, 2010 – University housing official check-in for remaining residents**

APPLICATION AND ASSIGNMENT TIMELINE



- **August 30, 2010, 4 p.m.** – Last date to check in before cancellation of contract and application of no-show fee – Room assignments will be held no later than 4 p.m. on the first day of class. If you anticipate arriving after classes begin, you must submit a written request to Housing and Residence Life and receive approval prior to August 23, 2010. Late check-ins that are not approved by Housing and Residence Life may result in a room assignment change or contract cancellation with the application of a no-show fee of \$200.
- **August 30, 2010** – First day of fall semester
- **September 13, 2010** – Fall consolidation begins – During this time, students living in Housing and Residence Life apartments or suites that are not full are moved to new locations to maintain full occupancy. This is done to allow housing to begin rehabilitating apartments for the next semester, to discontinue the use of electricity to the newly vacated locations, and to keep living arrangements equitable.
- **November 29, 2010** – Sign-up for winter break extension begins*
- **December 10, 2010** – Last day to sign up for winter break extension with no penalty
- **December 11, 2010** – Sign-up for winter break extension with \$50 penalty*
- **December 17, 2010** – University housing closes for winter break
- **January 7, 2011** – University housing opens for spring 2011 semester
- **January 10, 2011** – First day of spring semester
- **January 24, 2011** – Spring consolidation begins – During this time, students living in Housing and Residence Life apartments or suites that are not full are moved to new locations to maintain full occupancy. This is done to allow housing to begin rehabilitating apartments for the next semester, to discontinue the use of electricity to the newly vacated locations, and to keep living arrangements equitable.
- **February 21-25, 2011** – Contract renewal for 2011–2012 academic year – Contract renewal is the time when current residents can reserve their rooms for the 2011-2012 academic year. Returning students who renew during this period are given “priority status” and are reassigned first.
- **April 1, 2011** – Sign-up for summer housing begins
- **April 29, 2011** – Last day to sign up for summer housing with no penalty
- **April 30, 2011** – Sign-up for summer housing with \$50 penalty begins
- **May 6, 2011** – Last day of spring 2011 semester
- **May 8, 2011** – University housing closes—all residents must check out by 4 p.m.

* Residents from Vanderburgh (IN), Henderson (KY), White (IL), Gallatin (IL), Posey (IN), Gibson (IN), and Warrick (IN) counties may not sign up for winter break extension.

WINTER, SUMMER, AND DISABILITY HOUSING



Winter Break Housing

For safety and security reasons, and because the University is officially closed during a portion of the winter holiday period, University apartments and residence halls are closed from December 17, 2010, through January 7, 2011. The Residence Life Center is closed and mail service is held from December 23, 2010, through January 3, 2011.

Students wishing to stay during the winter break period must sign up by December 10, 2010, (online or at the Housing and Residence Life Center) and provide a compelling reason for needing to remain in housing during the break period. Approvals have included requests such as involvement in University-sponsored events, international residency, etc. **Residents with permanent addresses in Vanderburgh (IN), Warrick (IN), Henderson (KY), White (IL), Gallatin (IL), Posey (IN), or Gibson (IN) counties are not eligible to stay for the winter break.**

Students who apply for a winter break extension after December 10, 2010, will be charged \$50. Students who are discovered living on campus without authorization during the winter break will be charged \$300 and face disciplinary action.

Summer Housing

University housing is available during the summer terms. Students wishing to reside in summer housing must do the following:

- Be enrolled in at least three hours each summer session and maintain this enrollment
- Fill out a Summer Housing and Residence Life Contract (available April 1, 2011)
- Adhere to all policies and procedures as outlined in the 2010-2011 Housing/Food Services Booklet
- Relocate to the designated summer housing area

Accommodations for students with disabilities

Housing and Residence Life is committed to providing access and opportunity for all students. The University complies with the Americans with Disabilities Act and will attempt to provide reasonable accommodations for individuals with disabilities. Room and roommate assignments can be modified at the discretion of the director.

In order for USI to serve you better, please do the following:

1. Indicate any special services you need on the Housing/Food Services Contract.
2. Students with a documented disability are asked to contact the USI Counseling Center, 8600 University Boulevard, Evansville, IN, 47712, or by telephone at 812/464-1867, in addition to submitting this contract and deposit.

While USI will make every effort to provide what is needed, requests for accommodations cannot be assured for students applying less than 60 days prior to the beginning of the term for which the accommodations are needed.

The University of Southern Indiana does not discriminate on the basis of race, sex, religion, disability, age, national origin, sexual orientation, or status as a disabled veteran or veteran of the Vietnam era. Requests based on these discriminatory factors will not be honored.

HOUSING PLACEMENT



1. Priority Date

a. New Students—Your priority date is the date that your USI housing file is complete—which means your contract and deposit have both been received. For example, if you send your contract in on February 1, 2010, and your deposit is not received until April 15, 2010, your priority date will be April 15, 2010.

b. Current Residents – Current residents are automatically placed in their requested locations based on their sign-up during Contract Renewal. After Contract Renewal, current residents are put into the overall assignment pool with incoming residents, and their priority date is the date they filled out their contract.

c. Current USI students returning from off campus, or those who have never lived on campus—Your priority date is the date that your USI housing file is complete—which means your contract and deposit have both been received. For example, if you send your contract in on February 1, 2010, and your deposit is not received until April 15, 2010, your priority date will be April 15, 2010.

2. Housing Choices

a. If you have a requested roommate – Make sure to coordinate your housing choices. For example, if you want to live together in a residence hall, you should both make residence hall, four-person/two-bedroom suite, your first choice. If your housing choice does not match, you will both be placed in your room preference indicated on your contract.

b. If you have applied for and been accepted to a Living Learning Community – This choice will supersede any other choices you make, including roommate choices, unless you are both accepted to the same Living Learning Community.

c. If you choose a super single room – If space is available, we will assign you to a super single room. If space is not available, you will be assigned to a higher occupancy configuration.

3. How we assign—Our assignment process works this way:

Room assignments are done at the discretion of the Housing and Residence Life office. Every effort will be made to meet requests made by stated deadlines. Changes to assignments can be made to meet the needs of the department or University.

- First – We look at your priority date.
- Second – We look to see if you've been accepted to a Living Learning Community.
- Third – We look to see if you have a mutual roommate choice received by the priority March 1 deadline. If there is one and your room preference matches, you are grouped together. **Roommate requests supersede room location requests.**
- Fourth – We look at your housing preference.
- Fifth – We assign you to one of your housing choices, if available, and with your preferred roommate, if one has been chosen and you met the deadline.
- Sixth – **If your exact choice cannot be met, we assign you to a location with an available space.**

Late Applicants

Historically, later applicants are placed in pending status. While students placed in pending status may have a housing spot, some students may start the year in a temporary assignment.* Placement is made when space is available.

*Temporary Assignment: Some students may start the year in a temporary placement, which will have the full array of amenities and services. Permanent assignments open up as the year begins, and most students are permanently placed in the first few weeks of the fall semester.

PAYMENTS AND CONTRACTS



Payments

Payments for room and meal plan are placed on your overall University bill and are due when bills are due. Housing and meal plan charges will be placed on your bill separately. Deposit payments are due at the time you submit your contract. Deposits are \$200.

Contracts

Read the reverse side of your contract carefully before signing it. If you have any questions, contact us before you sign at 812/468-2000, email us at living@usi.edu, or visit the web site at www.usi.edu/res.

All students living in University housing sign a contract for the academic year

If you leave your residence before the end of the academic year in May 2011, you will be charged a contract breakage fee and will lose your deposit. If circumstances beyond your control require you to break your contract, you may appeal the contract breakage fee.

You may cancel your contract on or before June 1, 2010, with no penalty. After June 1, 2010, and before August 27, 2010, you will forfeit your \$200 deposit if you cancel. After August 27, 2010, you are subject to the cancellation schedule for Residence Life. See the back of your contract form for specific information.

Rates

The USI Board of Trustees and University administration reserve the right to change room and board rates at any time. Changes in housing/food services rates will not be considered grounds for contract termination.

See the food service section on page 18 for meal plan rates.

Housing rates per semester per student (contracts are for a full academic year):

Residence Halls

Four-person/two-bedroom suite \$1,780/semester

Campus Apartments – Two Bedroom

Four-person/two-bedroom apartment \$1,780/semester

Super single bedroom/
two-bedroom apt. (limited avail.) \$3,185/semester

Campus Apartments – One Bedroom (limited avail.)

Two-person/one-bedroom apartment \$2,150/semester

Super single bedroom/
one-bedroom apt. (limited avail.) \$3,995/semester

Please Note: In the event of a housing shortage, Housing and Residence Life reserves the right to place students in temporary housing. Once a [permanent space is available the resident will be required to move. **Assignments are made on a first-come, first-served basis. If a temporary assignment is not available, the contract will not be accepted.**

COMPLETING YOUR CONTRACT



Read the entire contract booklet before you complete a contract form. Instructions and the link to the online contract can be found at www.usi.edu/res. Paper contracts are available upon request. Be sure to respond to all items and to sign and date the contract form before returning it.

Information to provide on the contract includes:

- Indicate your preference for residency during the 2010-2011 academic year.
- Indicate required personal information.
- Emergency contact—give an emergency contact person and requested information.
- Indicate any special services you need (e.g. disabilities, medical concerns, etc.).
- To help Housing and Residence Life make better roommate matches, indicate your answers to the five preference questions listed on the contract form.
- Under FERPA (Family Educational Right to Privacy Act), the University may disclose to parents information from the educational record of a student who is “dependent” under federal tax laws without the student’s consent.
- **Living Learning Communities** Indicate your preference of a Living Learning Community. Living Learning Communities are located in the residence halls and require a separate application for acceptance. See information about Living Learning Communities in this booklet. Applications can be found on the Housing and Residence Life web site at www.usi.edu.
- Select your top two preferences from the list for living environments. If space in your top two preferences is not available, Housing and Residence Life staff will assign you a space and you can request a room change starting the 12th day of class each semester. **Not receiving your preferences does not cancel this contract.**
- **Meal Plans** Select your preferred meal plan. Students who live in the residence halls must select either a Red, White, or Blue Eagle Meal Plan. Students in the residence halls who do not select a meal plan will automatically be assigned the White Eagle Plan.
- Indicate your roommate preference. You must provide us with the Eagle Access Card number and phone number for your preferred roommate. Unfortunately, we cannot guarantee your preference will be granted unless we receive both roommates’ contracts and deposits by March 1, 2010, and unless both roommates request each other (mutual request). **Failure to receive your preferred roommate does not invalidate this contract.**

Questions?

Contact us at 812/468-2000,
visit www.usi.edu/res,
or email us at living@usi.edu

