



University of  
Southern Indiana

# USI Campus Master Plan Presentation

June 8, 2012



# Development of USI

- 50<sup>th</sup> Anniversary of founding in 2015
- Southern Indiana Higher Education, Inc. (SIHE) purchased 1,400 acres of land in the mid 1960's and donated 300 acres to develop a branch campus of Indiana State University in Evansville
- SIHE developed student housing and gifted approximately \$30 million in housing to USI in the early 1990's
- SIHE dissolved in 2008 and gave the remaining 900 acres of land valued at \$3 million to the USI Foundation

# Campus in 2006



University of Southern Indiana

# Campus Master Plan 2006

## Core of Campus

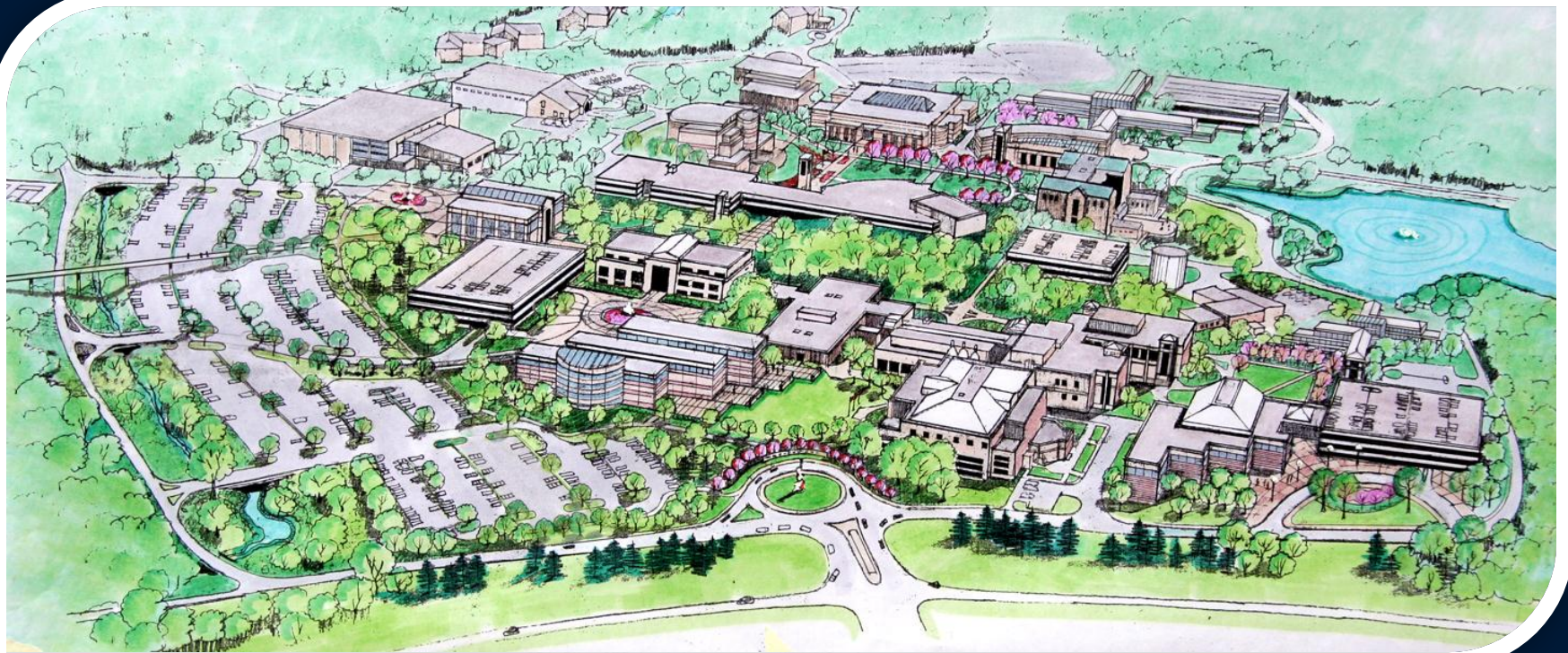

# Campus Master Plan 2006

## Entire Campus

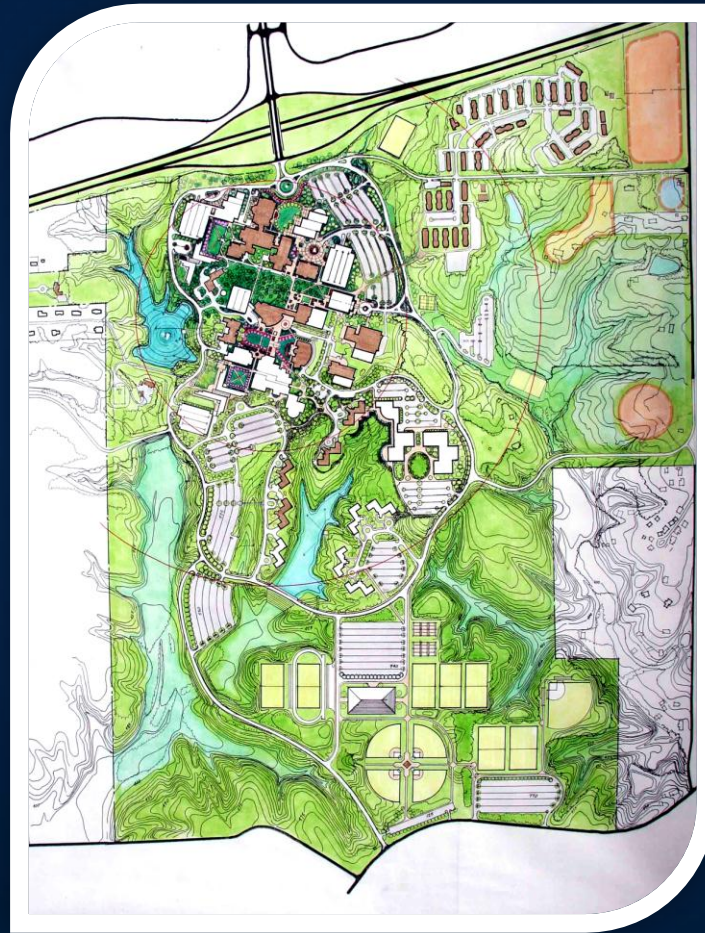

# Goals of 2006 Master Plan

- Continue to develop residential campus
- Improve the entrance to the campus
- Identify site locations for new facilities
- Develop a formal quadrangle to organize the development of the campus

# Campus in 2006

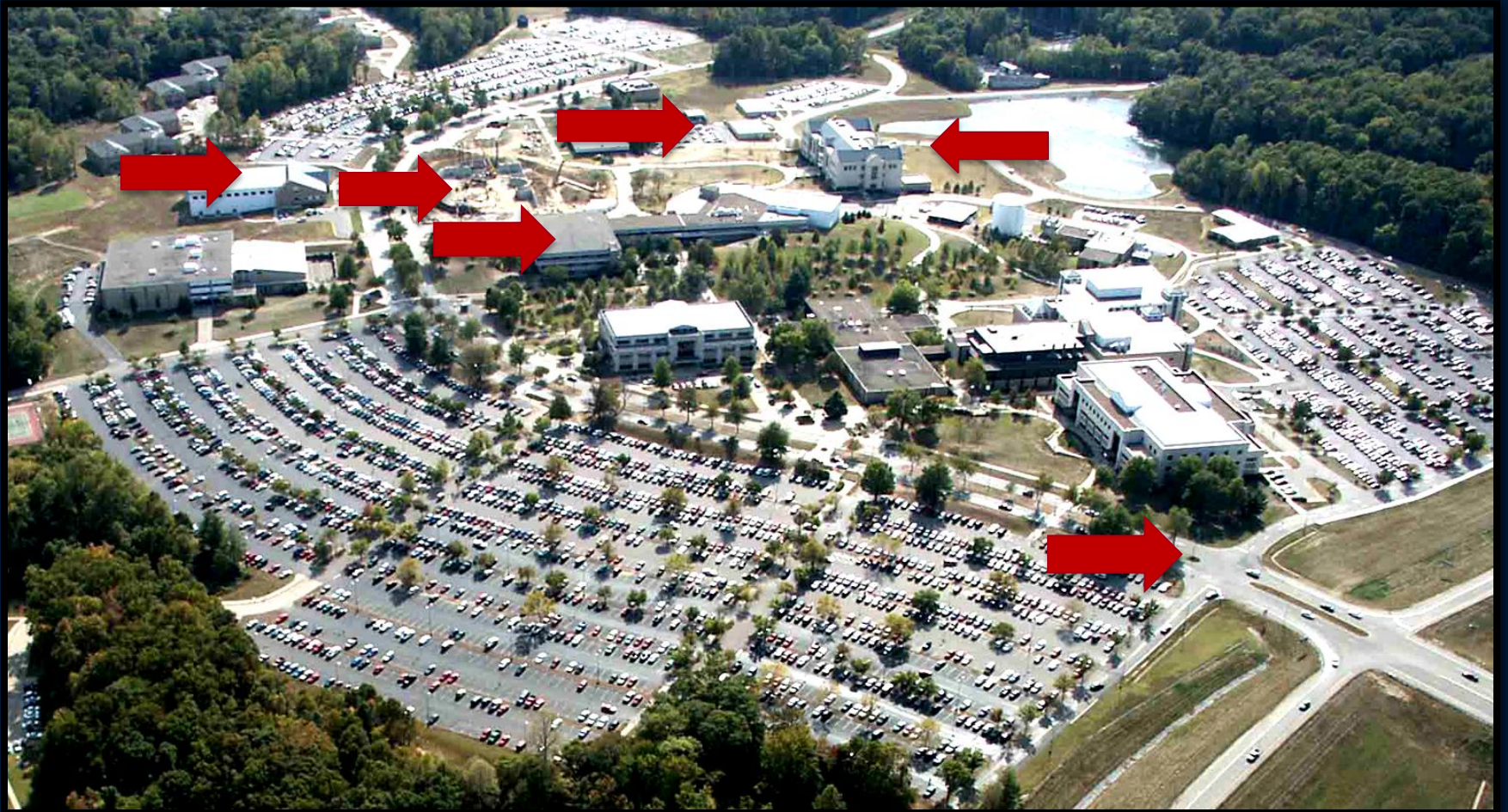

# Fountain and David L. Rice Library





# Recreation, Fitness, and Wellness Center



# McCutchan Art Center and Pace Galleries



# Entrance to Campus



# Business and Engineering Center



# Expansion of UC West



# Recreational Fields South of Campus



# Applied Engineering Center Opening Fall 2012



# Teaching Theatre Opening in 2014





# Ten-Year Capital Plan Priorities

- **2013-2015**
  - Classroom Renovation of Science Center and Expansion of Physical Activities Center
  - Student Residence Building Renovations
  - Renovation of Main Dining Area
  - Conference/Meeting Center
  - Visitor's Center

# Ten-Year Capital Plan Priorities

- **2015-2023**
  - Student Residence Building Renovations and Replacement
  - Repair and Renovation of Academic Facilities

# USI Campus and the Community

- The importance of physical space to learning:
  - Flexibility
  - Comfort – collaboration niches
  - 24/7 access to technology and support
  - Entire campus is an extension of the classroom

# Even in a “Virtual” World:

*“Space can have a powerful impact on learning; we cannot overlook space in our attempt to accomplish our goals.”*

Nancy Van Note Chism, 2006

# USI Campus in 2012

